

R.W. Samson

F&B-XII-110
PROVIDENCE, R. I.

CITY ENGINEER'S OFFICE
STREET LINE DEPT.

Dec. 16 1887

013471

PLAT OF

DAHLIA STREET

FROM BRATTLE ST. TO SALEM ST.

SCALE 50 FEET PER INCH.

Providence R.I.
This plat accompanies
our report of this date.

Changed to Waldo St.

Feb. 18. 1892.

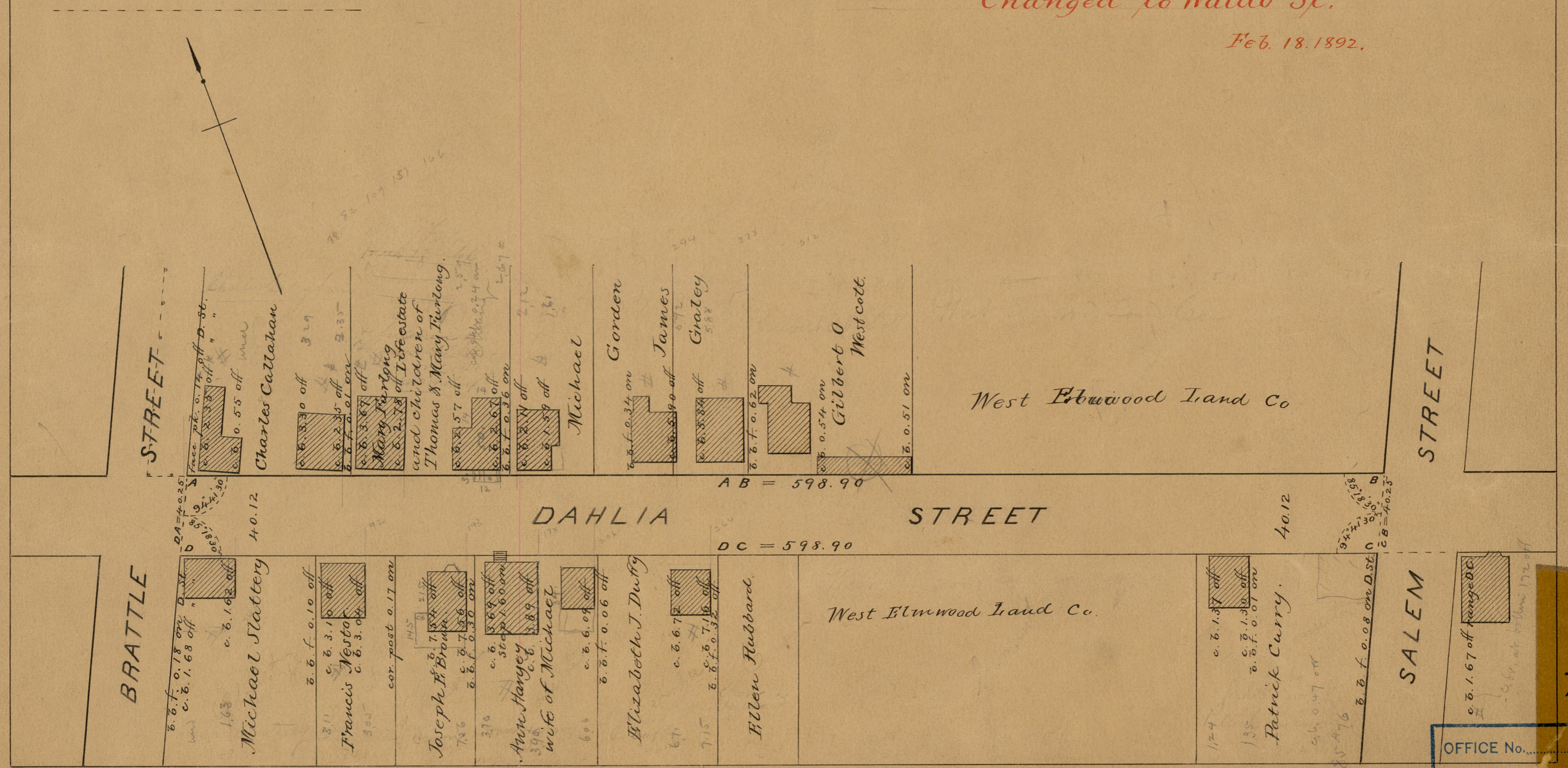

OFFICE No.	9418
DRAWER	83
SHEET	A-68

83
A-68